

ML23HS8L4360

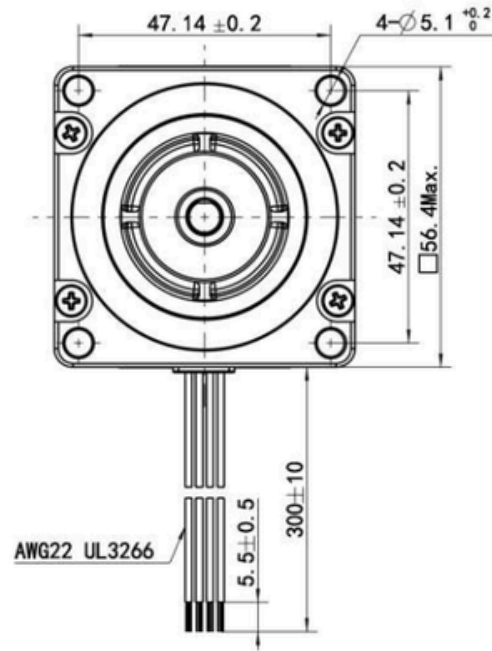

Wiring Diagram

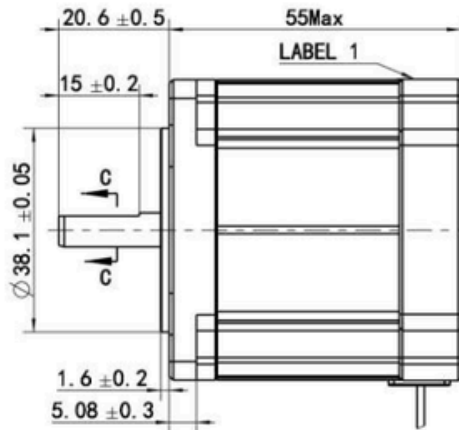
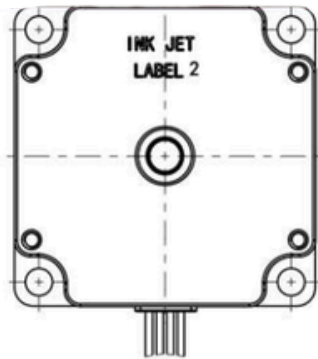
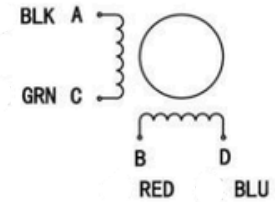

Exciting Sequence vs. Direction of Rotation

| STEP | A | B | C | D | CCW |
|------|---|---|---|---|-----|
| 1 | + | + | - | - | ↑ |
| 2 | - | + | + | - | |
| 3 | - | - | + | + | |
| 4 | + | - | - | + | |

Clockwise view from mounting side

1 Label1 Detail

MOONS' STEPPING MOTOR
 Insulation: Class B, 60VDC Max.
 3.6Amps Holding: 1.5Nm
 3000RPM Max. **CAUS**
 UL FILE No. E465363 XXX Factory ID

2 Label2 Detail

TYPE ML23HS8L4360
 XXXXXXXX YY/MM/DD
 Work Order Date Format

C-C(2:1)

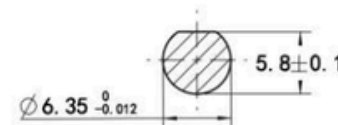

Hybrid Stepping Motor Specification

| | |
|----------------------|--|
| 1. Number of Phase | 2 |
| 2. Step Angle | 1.8° |
| 3. Rated Voltage | 2.27 V DC |
| 4. Rated Current | 3.6 Amp |
| 5. Holding Torque | 1.5 Nm Typ. (Two phase on/rated current) |
| 6. Phase Resistance | 0.63 ± 0.1ohm (20°C) |
| 7. Phase Inductance | 2.6 mH ± 20% (1kHz 1V rms) |
| 8. Rotor Inertia | 215 gcm ² |
| 9. Motor Weight | 0.6 kg |
| 10. Insulation Class | B (130°C) |

Unit: mm

FIRST ANGLE METHOD

Tolerance for linear and angular dimensions without individual tolerance indications

GB/T 1804-m eqv ISO 2768-1 : m
 Geometrical tolerance for features without individual tolerance indications
 GB/T 1184-K eqv ISO 2768-2 : K

UNLESS OTHERWISE SPECIFIED

Approve

Standardize

Process Review

Check

Design

PIVEXIN
TECHNOLOGY

| REV. | REVISION RECORD | DATE |
|------|---------------------|--------------|
| B1 | | 2023. 03. 27 |
| B0 | UL Update nameplate | 2017. 04. 01 |
| A | Original revision | 2013. 02. 28 |